

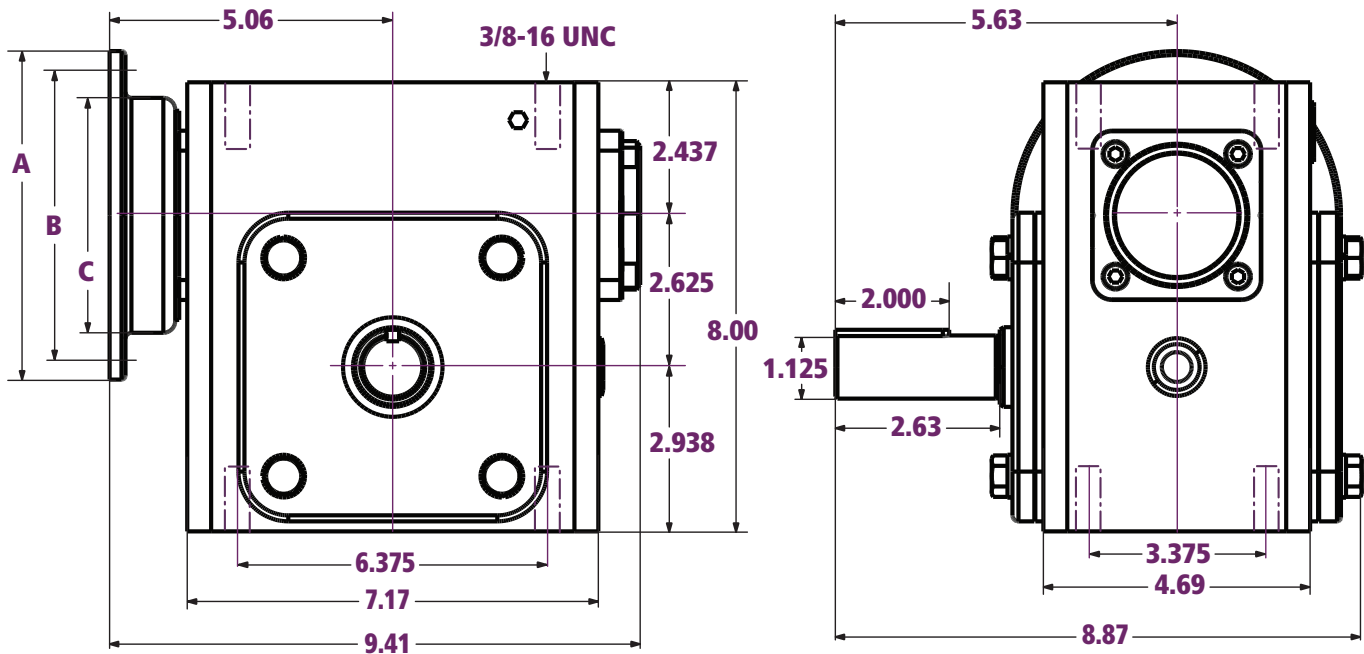

X262 Dimensions

All dimensions listed in inches



Motor Options & Dimensions (in)

NEMA Frame	Motor Shaft Dia. (in)	A	B	C
		OD Flange	Bolt Circle	Pilot Bore
56C	0.625	6.50	5.88	4.5
140TC	0.875			

Ratios

Nominal Ratios	Exact Ratios
5:1	5.3:1
10:1	10.7:1
15:1	15.5:1
20:1	19.5:1
30:1	30.0:1
40:1	40.0:1
50:1	50.0:1
60:1	60.0:1

Efficiency

Nominal Ratios	Efficiency (%)
5:1	≈ 93
10:1	≈ 90
15:1	≈ 87
20:1	≈ 83
30:1	≈ 76
40:1	≈ 72
50:1	≈ 67
60:1	≈ 66

Specifications

Center Distance	Weight (lbs)	Est. Oil Fill Amount* (oz)
2.625	48.4 [49.5 [†]]	33.8

*For Position 1

[†]Approximate weight for LR Handing

Output Shaft

Output Shaft (in)	Output Keyway (in)
1.125	1/4 x 1/8

Handing Types

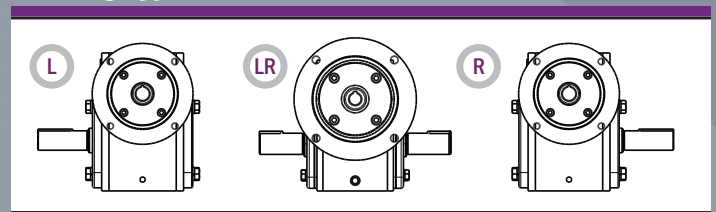

X262 Accessories

and X262 Base Kit Dimensions

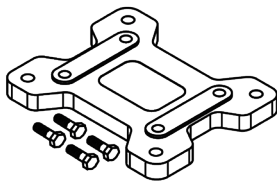
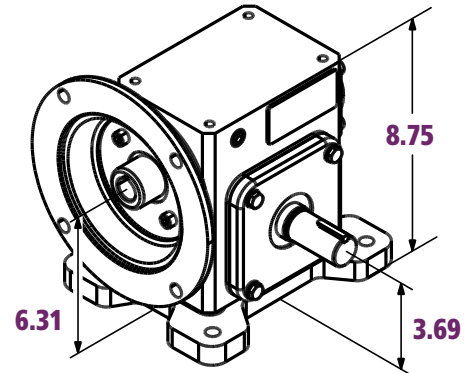
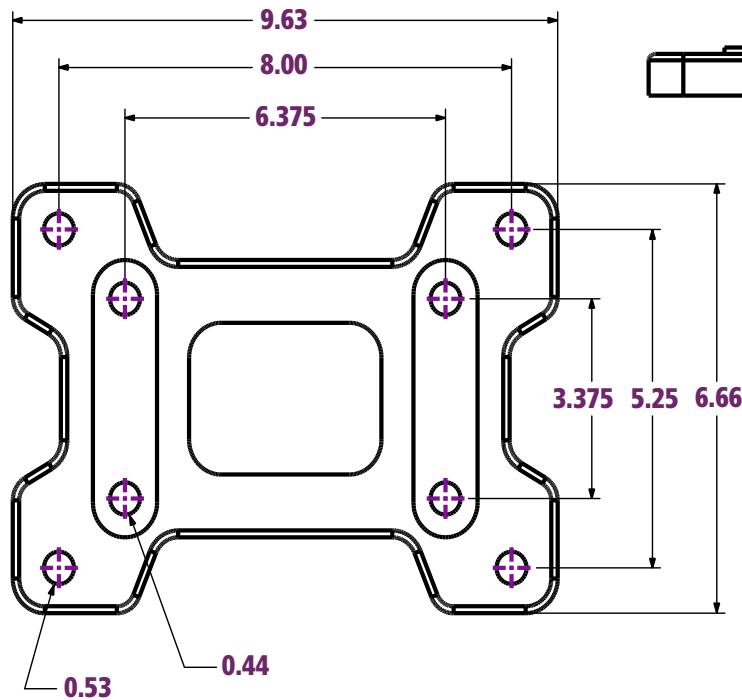

Foot Mounted Base Kit

XBK262

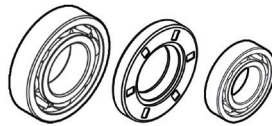

Component Repair Kit

XRK262

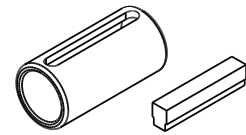

Input Quill Adapter Option

X143-56

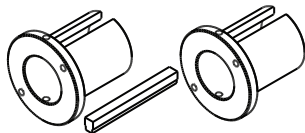

Output Bushing Kits*

Not Applicable

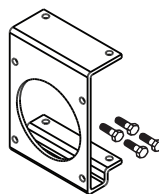

Output Bracket Kit*

XOB262

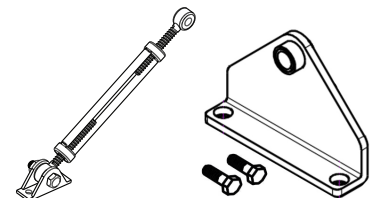

Torque Arm Kit*

XTA262

*Made to order.